



# HC28 SPECIFICATIONS

### BATTERY DESIGN

- Absorbent glass mat (AGM) technology
- 12V battery VRLA
- Can be mounted in any orientation except inverted.
- Can be install metal case and fitted with TP brass automotive adaptor on request
- US DOT and IATA certified non-spillable
- Sealed Construction (Non-Spillable Battery)
- Shipped fully charged - just install and go!

### PERFORMANCE FEATURES

- ✧ PHCA: 925A at 80°F (27°C);for 5 seconds
- ✧ CCA: 410A at 0°F (-18°C)
- ✧ CA/MCA: 530A at 32°F (0°C)
- ✧ HCA: 625A at 80°F (27°C)
- ✧ Reserve capacity: 48 minutes
- ✧ Short circuit current: 1300A
- ✧ Operation temperature range:
- ✧ 5°F (-15°C) to 122°F (50°C)

### Nominal Dimensions

Length		Width		Height		Total Height		Weight	
mm	in	mm	in	mm	in	mm	in	kg	pound
165±2	6.50	176±2	6.93	125±2	4.92	125±2	4.92	10.70	23.54

### HIGH RATE DISCHARGE AT 77°F (25°C)

5 sec.	10 sec.	20 sec.	30 sec.
925A	870A	765A	675A

### EXTENDED DISCHARGE AT 77°F (25°C) TO 10.02V

5min	15min	1hr	3hr	5hr	10hr	20hr
150A	70A	16.8A	7A	4.76A	2.6A	1.4A

### PHYSICAL CHARACTERISTICS

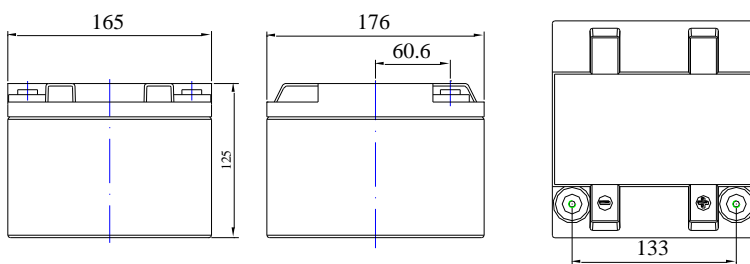

Terminal Type: M8:

unit:mm

